



DEPARTMENT OF THE ARMY  
CORPS OF ENGINEERS, JACKSONVILLE DISTRICT  
P. O. BOX 4970  
JACKSONVILLE, FLORIDA 32232-0019

October 26, 2020

Regulatory Division  
West Branch  
Tampa Section  
Gainesville Field Office  
SAJ-2020-03888(NW-JED)

Southwest Florida Water Management District  
Attn: Brian Starford  
2379 Broad Street  
Brooksville, FL 34606

Dear Mr. Starford:

The U.S. Army Corps of Engineers (Corps) assigned your application for a Department of the Army permit, which the Corps received on September 21, 2020, the file number SAJ-2020-03888. A review of the information and drawings provided indicates that the proposed work involves the discharge of 20 cubic yards of fill material into 0.009 acre of waters of the United States in order to replace a 12-foot-wide by 40-foot-long timber-pile bridge and stabilize the streambank and wingwalls with riprap revetment.

The work is more particularly described on the enclosed drawings which are incorporated into and made part of this authorization.

The activities subject to this permit are authorized pursuant to authorities under Section 404 of the Clean Water Act (33 U.S.C. § 1344). The project is located at 28057 State Road 471, in Section 15, Township 24 South, Range 23 East, Webster, Sumter County, Florida at the following coordinates:

Latitude: 28.393867°      Longitude: -82.004953°.

Your project, as depicted on the enclosed drawings, is authorized by Nationwide Permit (NWP) Number 14. In addition, project specific conditions have been enclosed. This verification is valid until **March 18, 2022**. Furthermore, if you commence or are under contract to commence this activity before the date that the relevant nationwide permit is modified or revoked, you will have 12 months from the date of the modification or revocation of the NWP to complete the activity under the present terms and conditions of this nationwide permit. Please access the U.S. Army Corps of Engineers' (Corps) Jacksonville District's Regulatory Internet page to access Internet links to view the Final Nationwide Permits, Federal Register Vol. 82, dated January 6, 2017,



specifically pages 1983 to 2008, and the table of Regional Conditions. The Internet page address is as follows:

<http://www.saj.usace.army.mil/Missions/Regulatory.aspx>

Please be aware this Internet address is case sensitive and should be entered as it appears above. Once there you will need to click on "Source Book"; and, then click on "Nationwide Permits." These files contain the description of the Nationwide Permit authorization, the Nationwide Permit general conditions, and the regional conditions, which apply specifically to this verification for NWP 14. Enclosed is a list of the six General Conditions, which apply to all Department of the Army authorizations. You must comply with all of the special and general conditions and any project specific condition of this authorization or you may be subject to enforcement action. In the event you have not completed construction of your project within the specified time limit, a separate application or re-verification may be required.

The following special conditions are included with this verification:

**1. Reporting Address:** The Permittee shall submit all reports, notifications, documentation and correspondence required by the general and special conditions of this permit to either (not both) of the following addresses:

a. For electronic mail (preferred): [SAJ-RD-Enforcement@usace.army.mil](mailto:SAJ-RD-Enforcement@usace.army.mil) (not to exceed 15 MB).

b. For standard mail: U.S. Army Corps of Engineers, Regulatory Division, Enforcement Section, P.O. Box 4970, Jacksonville, FL 32232-0019.

The Permittee shall reference this permit number, SAJ-2020-03888 (NW - JED), on all submittals.

**2. Commencement Notification:** Within 10 days from the date of initiating the work authorized by this permit the Permittee shall submit a completed "Commencement Notification" Form, enclosed herein.

**3. Self-Certification:** Within 60 days of completion of the work authorized by this permit, the Permittee shall complete the attached "Self-Certification Statement of Compliance" form enclosed herein, and submit it to the Corps. In the event that the completed work deviates in any manner from the authorized work, the Permittee shall describe the deviations between the work authorized by this permit and the work as constructed on the "Self-Certification Statement of Compliance" form. The description



of any deviations on the “Self-Certification Statement of Compliance” form does not constitute approval of any deviations by the Corps.

**4. Agency Changes/Approvals:** Should any other agency require and/or approve changes to the work authorized or obligated by this permit, the Permittee is advised a modification to this permit instrument is required prior to initiation of those changes. It is the Permittee’s responsibility to request a modification of this permit from the **Tampa** Permits Section. The Corps reserves the right to fully evaluate, amend, and approve or deny the request for modification of this permit.

**5. Posting of Permit:** The Permittee shall have available and maintain for review a copy of this permit and approved plans at the construction site.

**6. Cultural Resources/Historic Properties:**

a. No structure or work shall adversely affect impact or disturb properties listed in the *National Register of Historic Places* (NRHP) or those eligible for inclusion in the NRHP.

b. If during the ground disturbing activities and construction work within the permit area, there are archaeological/cultural materials encountered which were not the subject of a previous cultural resources assessment survey (and which shall include, but not be limited to: pottery, modified shell, flora, fauna, human remains, ceramics, stone tools or metal implements, dugout canoes, evidence of structures or any other physical remains that could be associated with Native American cultures or early colonial or American settlement), the Permittee shall immediately stop all work and ground-disturbing activities within a 100-meter diameter of the discovery and notify the Corps within the same business day (8 hours). The Corps shall then notify the Florida State Historic Preservation Officer (SHPO) and the appropriate Tribal Historic Preservation Officer(s) (THPO(s)) to assess the significance of the discovery and devise appropriate actions.

c. Additional cultural resources assessments may be required of the permit area in the case of unanticipated discoveries as referenced in accordance with the above Special Condition ; and if deemed necessary by the SHPO, THPO(s), or Corps, in accordance with 36 CFR 800 or 33 CFR 325, Appendix C (5). Based, on the circumstances of the discovery, equity to all parties, and considerations of the public interest, the Corps may modify, suspend or revoke the permit in accordance with 33 CFR Part 325.7. Such activity shall not resume on non-federal lands without written authorization from the SHPO for finds under his or her jurisdiction, and from the Corps.



d. In the unlikely event that unmarked human remains are identified on non-federal lands, they will be treated in accordance with Section 872.05 Florida Statutes. All work and ground disturbing activities within a 100-meter diameter of the unmarked human remains shall immediately cease and the Permittee shall immediately notify the medical examiner, Corps, and State Archeologist within the same business day (8-hours). The Corps shall then notify the appropriate SHPO and THPO(s). Based, on the circumstances of the discovery, equity to all parties, and considerations of the public interest, the Corps may modify, suspend or revoke the permit in accordance with 33 CFR Part 325.7. Such activity shall not resume without written authorization from the State Archeologist and from the Corps.

**7. Turbidity Barriers:** Prior to the initiation of any of the work authorized by this permit, the Permittee shall install floating turbidity barriers with weighted skirts that extend to within 1 foot of the bottom around all work areas that are in, or adjacent to, surface waters. The turbidity barriers shall remain in place and be maintained until the authorized work has been completed and all suspended and erodible materials have been stabilized. Turbidity barriers shall be removed upon stabilization of the work area.

**8. Erosion Control:** Prior to the initiation of any work authorized by this permit, the Permittee shall install erosion control measures along the perimeter of all work areas to prevent the displacement of fill material outside the work area into waters of the United States. Immediately after completion of the final grading of the land surface, all slopes, land surfaces, and filled areas shall be stabilized using sod, degradable mats, barriers, or a combination of similar stabilizing materials to prevent erosion. The erosion control measures shall remain in place and be maintained until all authorized work is completed and the work areas are stabilized.

**9. Fill Material:** The Permittee shall use only clean fill material for this project. The fill material shall be free from items such as trash, debris, automotive parts, asphalt, construction materials, concrete block with exposed reinforcement bars, and soils contaminated with any toxic substance, in toxic amounts in accordance with Section 307 of the Clean Water Act.

This letter of authorization does not obviate the necessity to obtain any other Federal, State, or local permits, which may be required. Prior to the initiation of any construction, projects qualifying for this Nationwide permit must qualify for an exemption under section 403.813(1), Florida Statutes or 373.406, Florida Statutes, or otherwise be authorized by the applicable permit required under Part IV of Chapter 373, Florida Statutes, by the Department of Environmental Protection, a water management district under section 373.069, Florida Statutes, or a local government with delegated authority under section 373.441, Florida Statutes, and receive Water Quality Certification and



applicable Coastal Zone Consistency Concurrence or waiver thereto, as well as any authorizations required for the use of state-owned submerged lands under Chapter 253, Florida Statutes, and, as applicable, Chapter 258, Florida Statutes. You should check State-permitting requirements with the Florida Department of Environmental Protection or the appropriate water management district.

This letter of authorization does not include conditions that would prevent the 'take' of a state-listed fish or wildlife species. These species are protected under sec. 379.411, Florida Statutes, and listed under Rule 68A-27, Florida Administrative Code. With regard to fish and wildlife species designated as species of special concern or threatened by the State of Florida, you are responsible for coordinating directly with the Florida Fish and Wildlife Conservation Commission (FWC). You can visit the FWC license and permitting webpage (<http://www.myfwc.com/license/wildlife/>) for more information, including a list of those fish and wildlife species designated as species of special concern or threatened. The Florida Natural Areas Inventory (<http://www.fnai.org/>) also maintains updated lists, by county, of documented occurrences of those species.

This letter of authorization does not give absolute Federal authority to perform the work as specified on your application. The proposed work may be subject to local building restrictions mandated by the National Flood Insurance Program. You should contact your local office that issues building permits to determine if your site is located in a flood-prone area, and if you must comply with the local building requirements mandated by the National Flood Insurance Program.

If you are unable to access the internet or require a hardcopy of any of the conditions, limitations, or expiration date for the above referenced NWP, please contact me by telephone at 352-264-7672.

Thank you for your cooperation with our permit program. The Corps Jacksonville District Regulatory Division is committed to improving service to our customers. We strive to perform our duty in a friendly and timely manner while working to preserve our environment. We invite you to complete our automated Customer Service Survey at [http://corpsmapu.usace.army.mil/cm\\_apex/f?p=regulatory\\_survey](http://corpsmapu.usace.army.mil/cm_apex/f?p=regulatory_survey). Please be aware this Internet address is case sensitive; and, you will need to enter it exactly as it appears above. Your input is appreciated – favorable or otherwise.



Sincerely,

James Davidson  
Project Manager

Enclosures:

Transfer Request (1 page)  
General Conditions (1 page)  
Commencement Notification (1 page)  
Self-Certification Form (1 page)  
Project Plans (7 pages)

cc:

CESAJ-RD-E



GENERAL CONDITIONS  
33 CFR PART 320-330

1. The time limit for completing the work authorized ends on **March 18, 2022**.
2. You must maintain the activity authorized by this permit in good condition and in conformance with the terms and conditions of this permit. You are not relieved of this requirement if you abandon the permitted activity, although you may make a good faith transfer to a third party in compliance with General Condition 4 below. Should you wish to cease to maintain the authorized activity or should you desire to abandon it without a good faith transfer, you must obtain a modification of this permit from this office, which may require restoration of the area.
3. If you discover any previously unknown historic or archeological remains while accomplishing the activity authorized by this permit, you must immediately notify this office of what you have found. We will initiate the Federal and state coordination required to determine if the remains warrant a recovery effort or if the site is eligible for listing in the National Register of Historic Places.
4. If you sell the property associated with this permit you must obtain the signature of the new owner in the space provided and forward a copy of the permit to this office to validate the transfer of this authorization.
5. If a conditioned water quality certification has been issued for your project, you must comply with the conditions specified in the certification as special conditions to this permit. For your convenience, a copy of the certification is attached if it contains such conditions.
6. You must allow a representative from this office to inspect the authorized activity at any time deemed necessary to ensure that it is being or has been accomplished in accordance with the terms and conditions of your permit.



**DEPARTMENT OF THE ARMY PERMIT TRANSFER REQUEST**

**PERMIT NUMBER: SAJ-2020-03888(NW-JED)**

When the structures or work authorized by this permit are still in existence at the time the property is transferred, the terms and conditions of this permit will continue to be binding on the new owner(s) of the property. Although the construction period for works authorized by Department of the Army permits is finite, the permit itself, with its limitations, does not expire.

To validate the transfer of this permit and the associated responsibilities associated with compliance with its terms and conditions, have the transferee sign and date below and mail to the U.S. Army Corps of Engineers, Enforcement Section, Post Office Box 4970, Jacksonville, FL 32232-0019 or electronic mail at [saj-rd-enforcement@usace.army.mil](mailto:saj-rd-enforcement@usace.army.mil).

\_\_\_\_\_  
(TRANSFEREE-SIGNATURE)

\_\_\_\_\_  
(SUBDIVISION)

\_\_\_\_\_  
(DATE)

\_\_\_\_\_  
(LOT)

\_\_\_\_\_  
(BLOCK)

\_\_\_\_\_  
(NAME-PRINTED)

\_\_\_\_\_  
(STREET ADDRESS)

\_\_\_\_\_  
(MAILING ADDRESS)

\_\_\_\_\_  
(CITY, STATE, ZIP CODE)



## **SELF-CERTIFICATION STATEMENT OF COMPLIANCE**

*Within sixty (60) days of completion of the authorized work, submit this form via electronic mail to [saj-rd-enforcement@usace.army.mil](mailto:saj-rd-enforcement@usace.army.mil) (preferred, not to exceed 15MB) **or** by standard mail to U.S. Army Corps of Engineers, Enforcement Section, P.O. Box 4970, Jacksonville, FL 32232-0019.*

1. **Department of the Army Permit Number:** SAJ-2020-03888(NW-JED)

2. **Permittee Information:** Name: \_\_\_\_\_

Email: \_\_\_\_\_

Address: \_\_\_\_\_

\_\_\_\_\_

Phone: \_\_\_\_\_

3. **Date Authorized Work Started:** \_\_\_\_\_ **Completed:** \_\_\_\_\_

4. **Contact to Schedule Inspection:** Name: \_\_\_\_\_

Email: \_\_\_\_\_

Phone: \_\_\_\_\_

5. **Description of Authorized Work (e.g. bank stabilization, fill placed within wetlands, docks, dredging, etc.):** \_\_\_\_\_

\_\_\_\_\_

6. **Acreage or Square Feet of Impacts to Waters of the United States:** \_\_\_\_\_

7. **Describe Mitigation completed (if applicable):** \_\_\_\_\_

\_\_\_\_\_

8. **Describe any Deviations from Permit (attach drawing(s) depicting the deviations):**

\_\_\_\_\_

\*\*\*\*\*

I certify that all work and mitigation (if applicable) was done in accordance with the limitations and conditions as described in the permit. Any deviations as described above are depicted on the attached drawing(s).

\_\_\_\_\_  
Signature of Permittee

\_\_\_\_\_  
Printed Name of Permittee

\_\_\_\_\_  
Date

Dated 9/18/2019



## **COMMENCEMENT NOTIFICATION**

*Within ten (10) days of initiating the authorized work, submit this form via electronic mail to [saj-rd-enforcement@usace.army.mil](mailto:saj-rd-enforcement@usace.army.mil) (preferred, not to exceed 15 MB) **or** by standard mail to U.S. Army Corps of Engineers, Enforcement Section, P.O. Box 4970, Jacksonville, FL 32232-0019.*

**1. Department of the Army Permit Number:**SAJ-2020-03888(NW-JED)

**2. Permittee Information:**

Name: \_\_\_\_\_

Email: \_\_\_\_\_

Address: \_\_\_\_\_

\_\_\_\_\_

Phone: \_\_\_\_\_

**3. Construction Start Date:** \_\_\_\_\_

**4. Contact to Schedule Inspection:**

Name: \_\_\_\_\_

Email: \_\_\_\_\_

Phone: \_\_\_\_\_

\_\_\_\_\_  
Signature of Permittee

\_\_\_\_\_  
Printed Name of Permittee

\_\_\_\_\_  
Date



# SWFWMD DEVIL'S CREEK BRIDGE REPLACEMENT 80' TIMBER PILE SUPPORTED 15 TON BRIDGE

## DRAWING INDEX

SHEET NUMBER	SHEET TITLE
1	COVER
2	EXISTING CONDITIONS PLAN
3	EROSION CONTROL PLAN
4	GENERAL PLAN & ELEVATION
5	DECK PLAN
6	BRIDGE SECTION
7	DETAILS

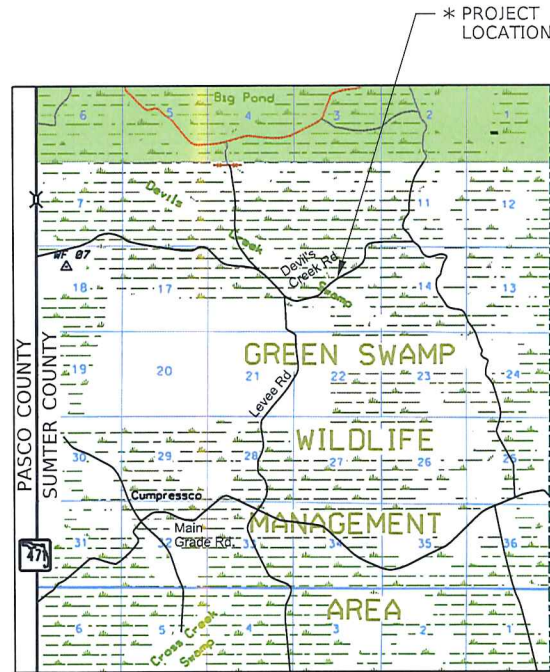

LOCATION MAP  
NOT TO SCALE

\* PROJECT IS LOCATED IN THE GREEN SWAMP WILDLIFE MANAGEMENT AREA (WMA).  
ENTRANCE IS LOCATED ON THE EAST SIDE OF HIGHWAY 471, 6.7 MILES NORTH OF THE US 98 / HIGHWAY 471 INTERSECTION.

### LIGHT LOAD USE ACCESS LOCATION:

GO EAST ON THE MAIN GRADE ROAD FOR 2.6 MILES TO THE LEVEE ROAD INTERSECTION.  
GO NORTHEAST ON LEVEE ROAD FOR 2.4 MILES TO THE INTERSECTION WITH DEVIL'S CREEK ROAD.  
GO EAST ON BULL BARN ROAD APPROXIMATELY 0.7 MILES TO BRIDGE LOCATION.

### HEAVY LOAD USE ACCESS LOCATION:

GO EAST ON THE MAIN GRADE ROAD FOR 5.5 MILES TO THE TANC ROAD INTERSECTION.  
GO NORTH ON TANC ROAD FOR 3.3 MILES TO THE INTERSECTION WITH BULL BARN ROAD.  
GO WEST ON BULL BARN ROAD APPROXIMATELY 0.7 MILES TO BRIDGE LOCATION.



# NOTE:

PLEASE REFER TO SWFWMD SURVEY, WORK ORDER 19-041, DATED 02/18/2019,  
FOR ALL APPLICABLE SURVEY INFORMATION. FIELD BOOK, PAGE NUMBER: 10/139, 66-80.





## LINE STYLE LEGEND

-  = Top Bank or Top of Berm
-  = Toe of Slope or Edge of Water
-  = Steel Cable

## TREE LEGEND

-  = Citrus Tree
-  = Maple Tree
-  = Oak Tree
-  = Palm Tree

## SYMBOLS LEGEND

-  = Bench Mark
-  = Sign
-  = Wood Post
-  = Steel Post
-  = Point of Elevation

Benchmark GPS 1001: Set 5/8" Iron Rod w/ Plastic Cap "SWFWMD Trav. Pt." Elev. 94.980 Feet  
Benchmark GPS 1002: Set 5/8" Iron Rod w/ Plastic Cap "SWFWMD Trav. Pt." Elev. 94.458 Feet

Existing Structure to be Completely Removed and Disposed of Offsite.

Existing Timber Piles to be Cut Off 1 Ft. below final Proposed Grade.

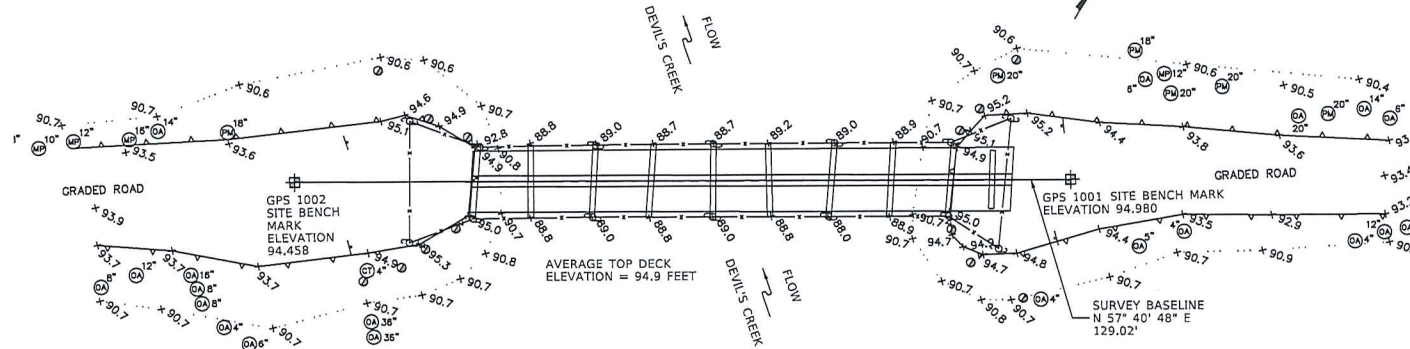



SECTION 15, TOWNSHIP 24 SOUTH, RANGE 23 EAST

# EROSION CONTROL PLAN NOTES:

1. CONTRACTOR SHALL SUBMIT EROSION CONTROL PLAN FOR APPROVAL BY THE ENGINEER OR DISTRICT REPRESENTATIVE PRIOR TO PLACEMENT.
2. ALL EROSION CONTROL MEASURES SHALL BE INSTALLED PRIOR TO THE COMMENCEMENT OF CONSTRUCTION ACTIVITIES TO THE SATISFACTION OF THE ENGINEER OR DISTRICT REPRESENTATIVE.
3. EROSION CONTROL MEASURES SHOWN ARE FOR BIDDING PURPOSES ONLY. CONTRACTOR SHALL INSTALL MEASURES SUITABLE TO THE CONDITIONS AT THE TIME OF CONSTRUCTION.
4. CONTRACTOR SHALL MAINTAIN ALL EROSION CONTROL MEASURES THROUGHOUT THE TERM OF THE CONTRACT UNTIL ACCEPTANCE.

## LINE STYLE LEGEND

- = Top Bank or Top of Berm
- = Toe of Slope or Edge of Water
- = Steel Cable
- = Floating Turbidity Barrier
- = Staked Turbidity Barrier

## TREE LEGEND

- ⊙ = Citrus Tree
- ⊙ = Maple Tree
- ⊙ = Oak Tree
- ⊙ = Palm Tree

## SYMBOLS LEGEND

- ⊕ = Bench Mark
- ⊕ = Sign
- ⊙ = Wood Post
- ⊕ = Steel Post
- + 25.2 = Point of Elevation

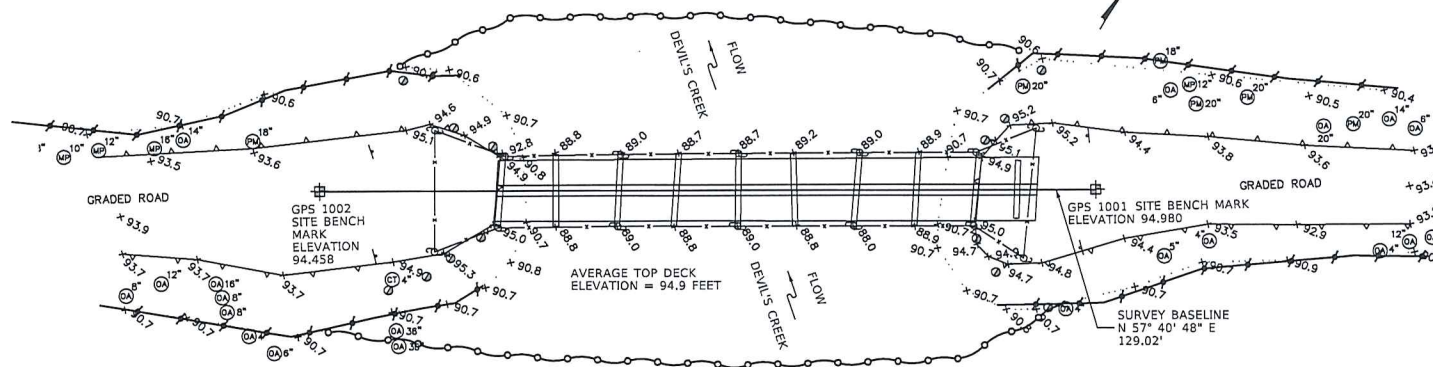

SOUTHWEST FLORIDA WATER MANAGEMENT DISTRICT  
PARCEL NUMBER 10-200-106

## EROSION CONTROL PLAN

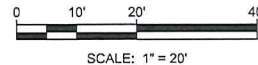

Southwest Florida  
Water Management District

NUMBER	DATE	REVISION
1		
2		
3		
4		
5		
6		
7		
8		
9		
10		

EXP U.S. Services Inc.  
400 N. TAMPA STREET  
SUITE 1650  
TAMPA, FL 33602 USA  
813-868-8943



DEVIL'S CREEK  
BRIDGE REPLACEMENT  
TIMBER PILE SUPPORTED  
15 TON BRIDGE

ENGINEER:  
BYRON DANLEY, P.E.  
REG. NO. 83585

PROJECT NUMBER
SHEET NUMBER 3 OF 7



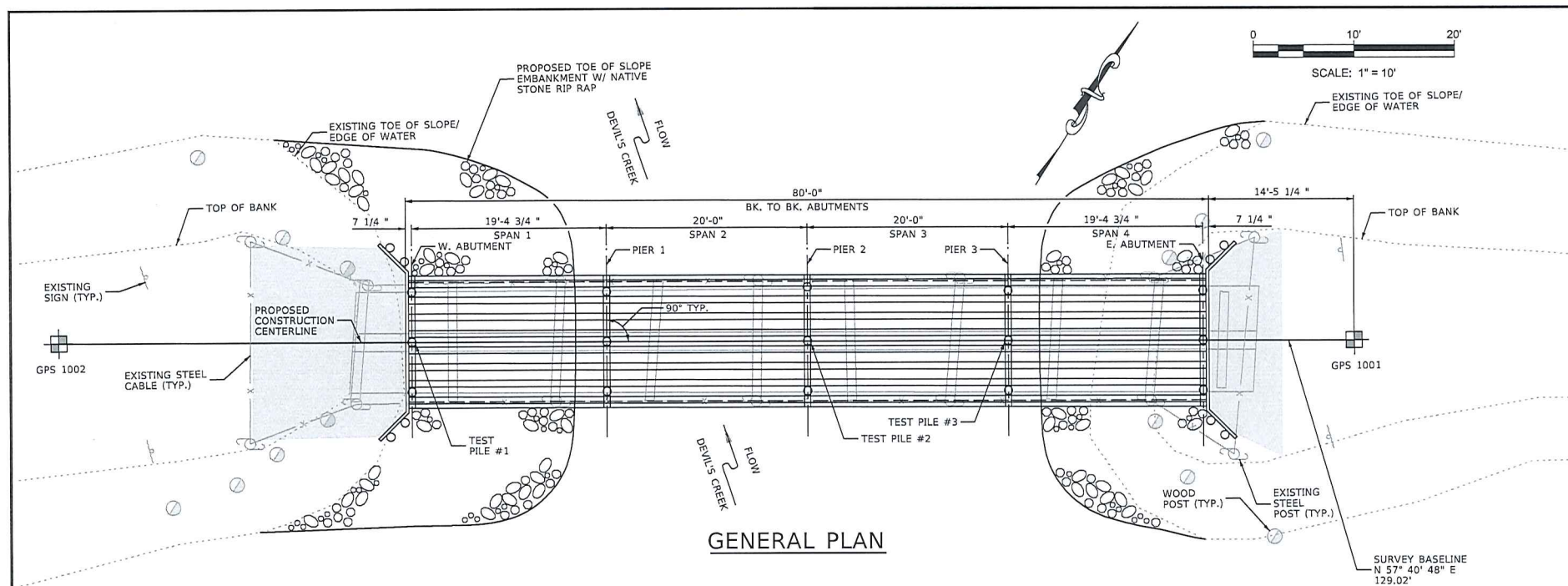

GENERAL PLAN

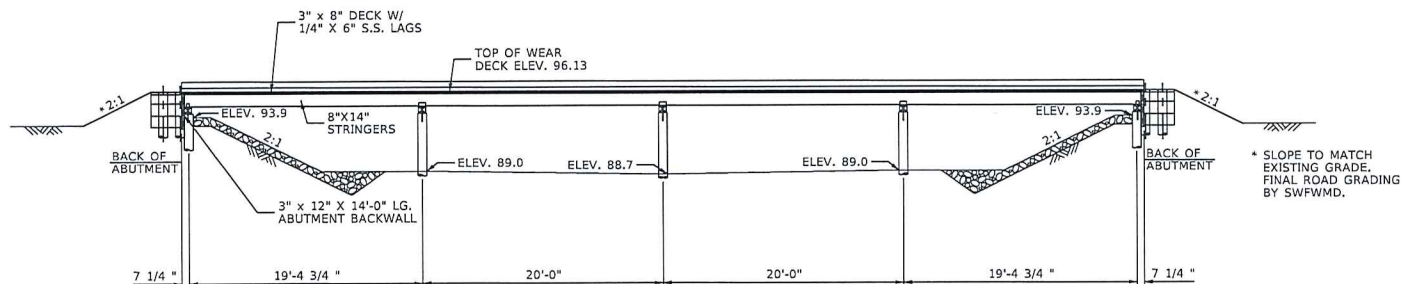

ELEVATION

NOTES:

1. CONSTRUCT EMBANKMENT CONES PRIOR TO DRIVING PILES.
2. BACKFILL ABUTMENTS AND WINGWALLS TO ELEV. 96.0 AFTER STRINGERS ARE PLACED.
3. ARMOR CONES W/ NATIVE STONE RIPRAP, SEE SHEET 7.

Southwest Florida  
Water Management District

NUMBER	DATE	DESCRIPTION
1		
2		
3		
4		
5		
6		
7		
8		
9		
10		
11		
12		
13		
14		
15		
16		
17		
18		
19		
20		
21		
22		
23		
24		
25		
26		
27		
28		
29		
30		
31		
32		
33		
34		
35		
36		
37		
38		
39		
40		
41		
42		
43		
44		
45		
46		
47		
48		
49		
50		
51		
52		
53		
54		
55		
56		
57		
58		
59		
60		
61		
62		
63		
64		
65		
66		
67		
68		
69		
70		
71		
72		
73		
74		
75		
76		
77		
78		
79		
80		
81		
82		
83		
84		
85		
86		
87		
88		
89		
90		
91		
92		
93		
94		
95		
96		
97		
98		
99		
100		

ISSUED FOR REVIEW

EXP U.S. Services Inc.  
400 N. TAMPA STREET  
SUITE 1650  
TAMPA, FL 33602 USA  
813-868-8943  
COA AA26002448 ©2019 EXP www.exp.com



DEVIL'S CREEK  
BRIDGE REPLACEMENT  
TIMBER PILE SUPPORTED  
15 TON BRIDGE

ENGINEER:  
BYRON DANLEY, P.E.  
REG. NO. 83585

PROJECT NUMBER  
SHEET NUMBER  
4 OF 7











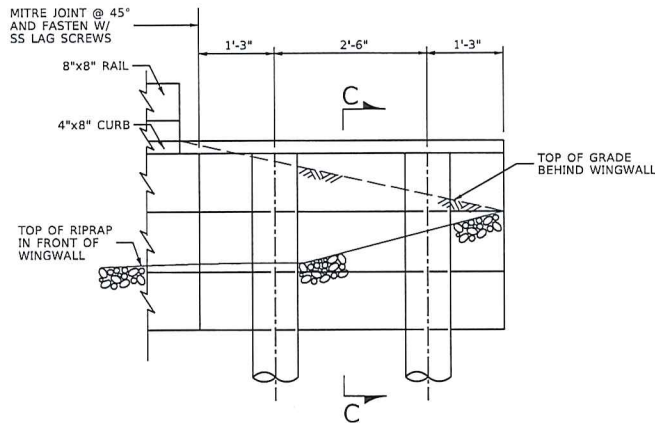

WINGWALL ELEVATION

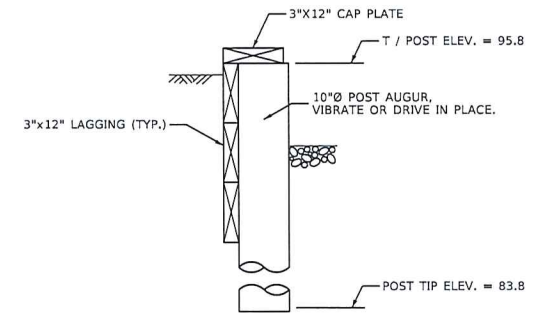

SECTION C-C  
THRU WINGWALL

LOCATION	EXT. OR INT.	CAPACITY	* EST. LENGTH
PIER BENT	EXTERIOR PILE	11 <sup>T</sup>	20'
	INTERIOR PILE	19 <sup>T</sup>	30'
ABUTMENT BENT	EXTERIOR PILE	9 <sup>T</sup>	17'
	INTERIOR PILE	16 <sup>T</sup>	29'

\* ESTIMATED LENGTHS ARE FROM TIP TO FINAL CUTOFF ELEVATION. LENGTHS DO NOT INCLUDE ADDITIONAL 15 FT. REQUIRED FOR TEST PILE LOCATIONS.

## PILE CAPACITIES AND ESTIMATED LENGTHS

MEMBER	AWPA TREATMENT CATEGORY
PILES AND POSTS	UC4C
10"x10" CROSSBEAMS	UC4A
8"x14" STRINGERS	UC3B
3"x8" DECKING	UC4A
3"x12" BACKWALL / WINGWALL	UC4C
4"x8" CURB BLOCK	UC3B
8"x8" CURB RAILING	UC3B

## TIMBER TREATMENT CATEGORIES

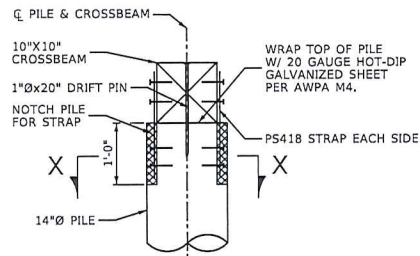

SECTION X-X

## PILE STRAP DETAIL

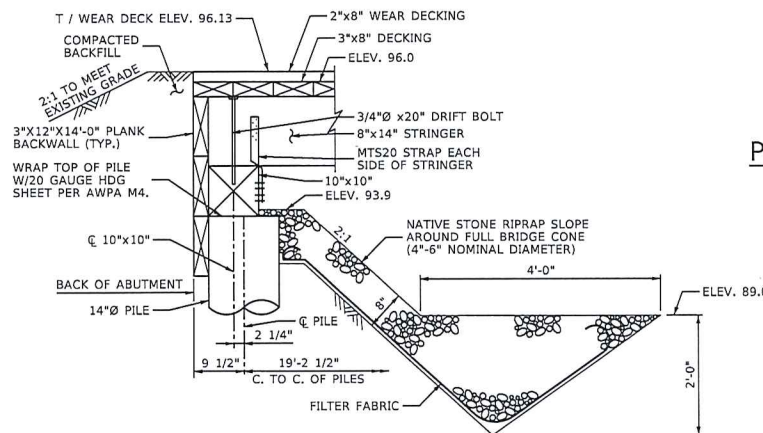

SECTION D-D  
THRU ABUTMENT BENT  
(SEE DWG. NO. 005)