

SURVEYORS REPORT

THE MAP AND REPORT ARE NOT FULL AND COMPLETE WITHOUT THE OTHER. (SEE SHEET INDEX IN TITLE BLOCK)

HORIZONTAL DATUM. ACCURACY AND ORIGIN:

HORIZONTAL VALUES (BEARINGS AND DISTANCES) SHOWN HEREON ARE BASED ON NORTH AMERICAN DATUM OF 1983 (NAD 1983/2011), FLORIDA STATE PLANE COORDINATE SYSTEM (FSPCS), WEST ZONE (902) UNITS ARE IN U.S. SURVEY FEET. COORDINATES OF FEATURES LOCATED HAVE AN EXPECTED ACCURACY OF 0.20 FEET. CONSIDER A SCALE FACTOR OF 0.9999411765 FEET (GROUND DISTANCES SHOWN ON MAP OF SURVEY). BEARINGS ARE BASED ON THE SURVEY BASELINE GPS 1002 TO GPS 1001 BEING N 57° 40' 48 E AS SHOWN ON THE MAP OF SURVEY.

THE HORIZONTAL VALUES SHOWN HEREON ARE DERIVED FROM REAL TIME KINEMATICS - GLOBAL NAVIGATION SATELLITE SYSTEM (RTK-GNSS) MEASUREMENTS, USING THE LEICA VIVA NRTK-GPS WITH THE FLORIDA PERMANENT REFERENCE NETWORK (FPRN), THE FPRN NETWORK IS BASED ON DIRECT TIES TO NATIONAL GEODETIC SURVEY (NGS) CONTROL STATIONS. THE HORIZONTAL ACCURACIES ARE VALIDATED USING NGS CONTROL STATION ZEPHYRHILLS CORS ARP (DF7990).

VERTICAL ACCURACY. DATUM AND ORIGIN:

ELEVATIONS ARE BASED ON VERTICAL CONTROL THAT CONFORMS TO THE STANDARDS FOR VERTICAL FEATURE ACCURACY DEFINED UNDER CHAPTER 5J-17.051, FLORIDA ADMINISTRATIVE CODE (F.A.C.).

GPS DERIVED ELEVATIONS WERE VERIFIED BY REDUNDANT MEASUREMENTS RESULTING IN A VERTICAL ACCURACY OF 0.20 FEET AT THE 95% CONFIDENCE LEVEL. THE VERTICAL VALUES SHOWN HEREON ARE DERIVED FROM REAL TIME KINEMATICS - GLOBAL NAVIGATION SATELLITE SYSTEM (RTK-GNSS) MEASUREMENTS, USING THE LEICA VIVA NRTK-GPS WITH THE FLORIDA PERMANENT REFERENCE NETWORK (FPRN), THE FPRN NETWORK IS BASED ON DIRECT TIES TO NGS CONTROL STATIONS. THE VERTICAL ACCURACIES ARE VALIDATED USING NGS CONTROL STATION F46 202 (AL8009).

SITE BENCH MARKS: GPS 1001 SET 5/8" IRON ROD WITH PLASTIC CAP "SWFWMD TRAV. PT." ELEVATION = 94.980 FEET, GPS 1002 SET 5/8" IRON ROD WITH PLASTIC CAP "SWFWMD TRAV. PT." ELEVATION = 94.458 FEET.

NOTES

THIS MAP, DATA AND REPORT OR THE COPIES THEREOF ARE NOT VALID WITHOUT THE SIGNATURE AND THE ORIGINAL RAISED SEAL OF A FLORIDA LICENSED SURVEYOR AND MAPPER. ADDITIONS OR DELETIONS TO THESE MAPS, DATA OR REPORTS BY OTHER THAN THE SIGNING PARTY OR PARTIES IS PROHIBITED BY LAW WITHOUT THE WRITTEN CONSENT OF THE SIGNING PARTY OR PARTIES. WHEN DATA IS DELIVERED IN DIGITAL FORM ONLY, NEITHER THE DATA NOR THE REPORT IS FULL AND COMPLETE WITHOUT THE OTHER.

SHEET INDEX

- SHEET 1: SURVEYORS REPORT, BRIDGE DETAIL AND VICINITY MAP
- SHEET 2: MAP OF SURVEY
- SHEET 3: SITE PHOTOGRAPHS

SECTION 15, TOWNSHIP 24 SOUTH, RANGE 23 EAST

VICINITY MAP
NOT TO SCALE

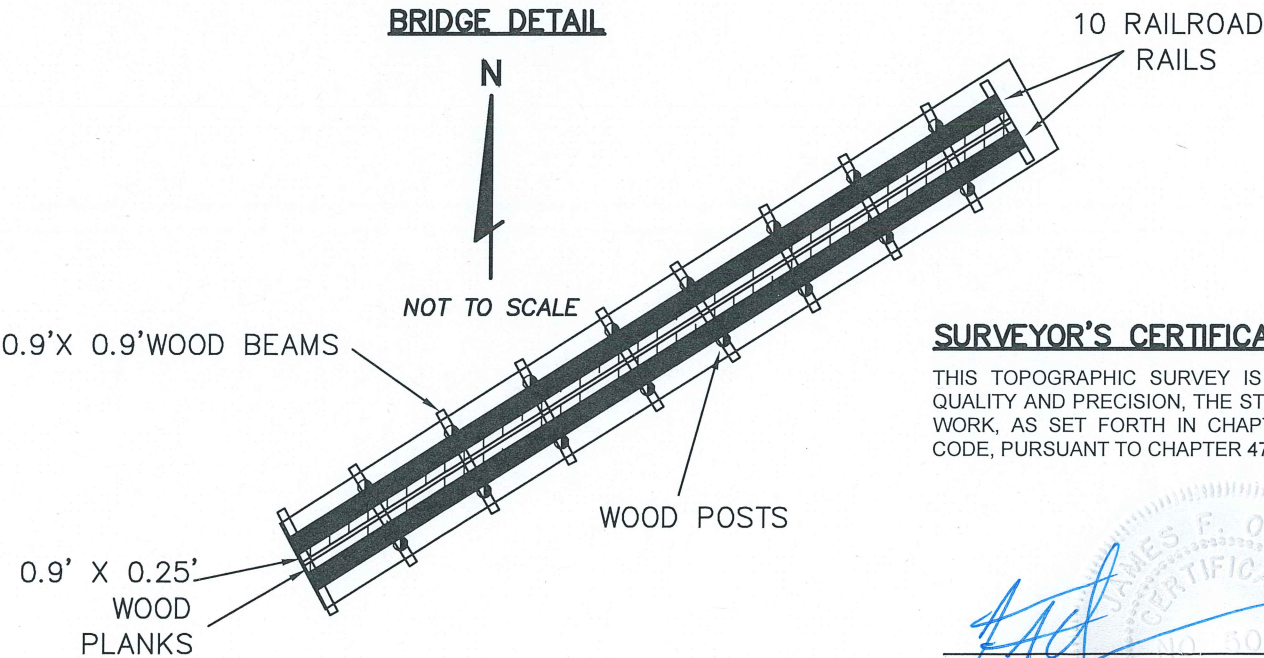
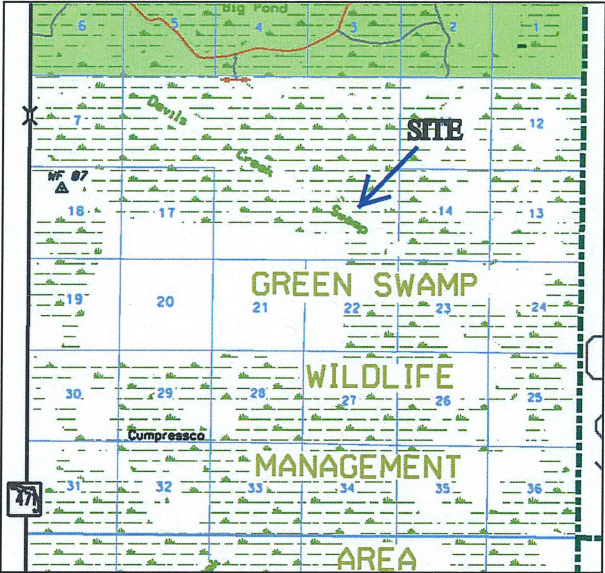

SURVEYOR'S CERTIFICATION

THIS TOPOGRAPHIC SURVEY IS CERTIFIED AS MEETING OR EXCEEDING, IN QUALITY AND PRECISION, THE STANDARDS OF PRACTICE APPLICABLE FOR THIS WORK, AS SET FORTH IN CHAPTER 5J-17, OF THE FLORIDA ADMINISTRATIVE CODE, PURSUANT TO CHAPTER 472 OF THE FLORIDA STATUTES.

[Signature]
James F. Owens, PSM
Florida Professional Surveyor and Mapper No. 5014

4.22.19
Date

Southwest Florida
Water Management District

WATERMATTERS.ORG · 1-800-423-1476

DATA COLLECTION BUREAU

TOPOGRAPHIC SURVEY

GREEN SWAMP BASIN
DEVILS CREEK BRIDGE
SURVEYORS REPORT

DATE OF SURVEY: 02/18/2019

SUMTER COUNTY

DRAWN BY: SMB

DATE DRAWN: 02/26/2019

WORK ORDER NO.: 19-041

SHEET 01 OF 03

AUTOCAD FILE: Worksheet 19-041.dwg

FIELD BOOK, PAGE NO.: 10/139, 66-80

SITE PHOTOGRAPHS

SECTION 15, TOWNSHIP 24 SOUTH, RANGE 23 EAST

P1



EAST VIEW

P2

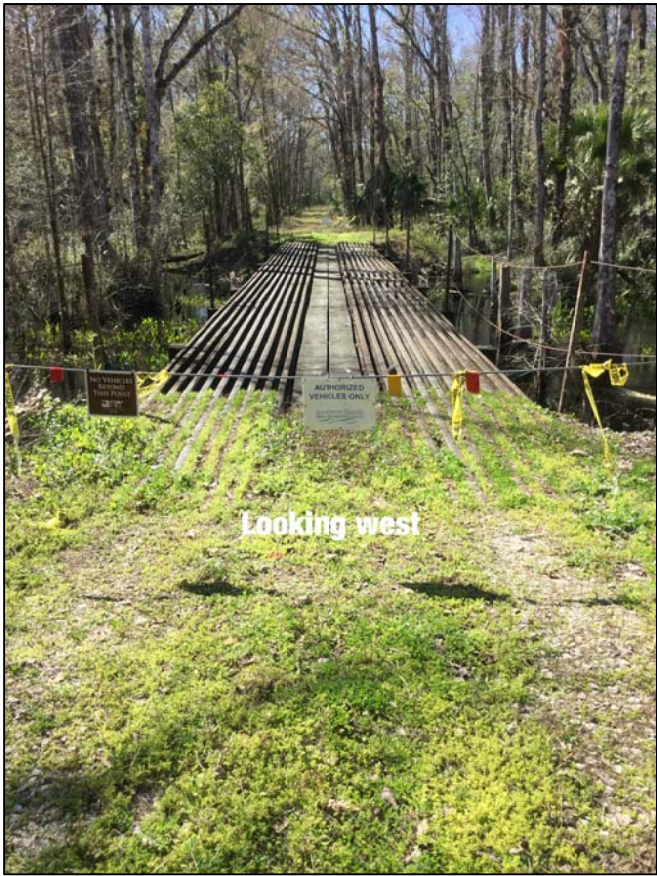

WEST VIEW

P3



UPSTREAM VIEW

P4



DOWNSTREAM VIEW

Southwest Florida
Water Management District

WATERMATTERS.ORG · 1-800-423-1476

DATA COLLECTION BUREAU

TOPOGRAPHIC SURVEY

**GREEN SWAMP BASIN
DEVILS CREEK BRIDGE
SITE PHOTOGRAPHS**

DATE OF SURVEY: 02/18/2019

SUMTER COUNTY

DRAWN BY: SMB

DATE DRAWN: 02/26/2019

WORK ORDER NO.: 19-041

SHEET 03 OF 03