

## **SWERP Training**

### **Overview, Applicant Handbook II and SWFWMD Specific Changes**

September 25, 2013

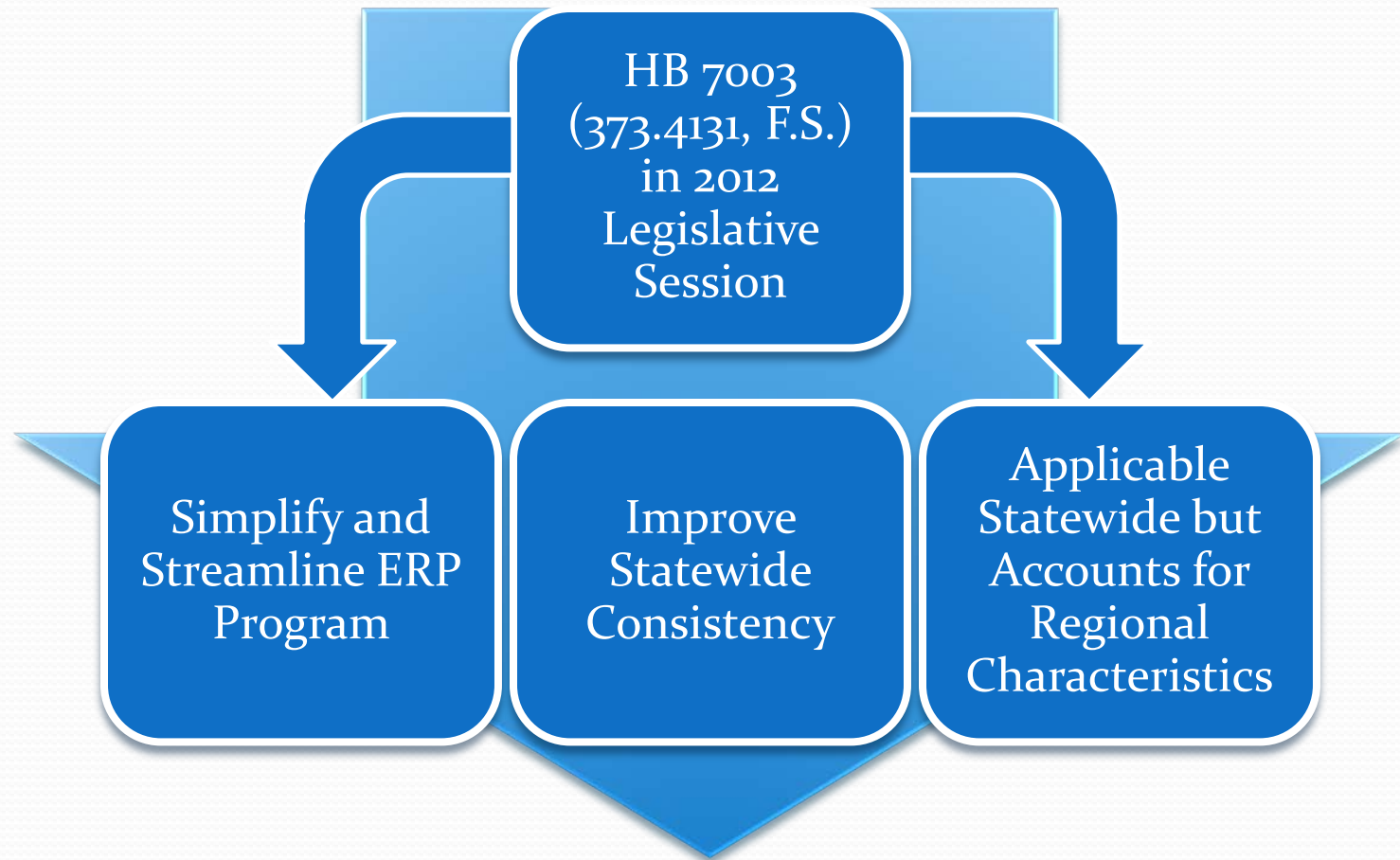

# SWERP Development

## 373.4131, FS – Requires SWERP to do the following:

- Consistent Permit Thresholds & Types
- Procedures for Review, Notices, Duration, Inspections, Certification
- Operational Requirements
- Exemptions & GPs (no significant adverse impacts individually or cumulatively)
- Standardized Fee Categories
- Standardized Forms & Electronic Submittals\*
- An Applicant's Handbook
- Grandfathering of specific activities

# Rule Structure

DEP ERP rules under Chapters 62-343, -346, and -341 were incorporated into 62-330, F.S.

ERP provisions of many WMD rules (40X-1, -4, -40, -400, etc.) were revised, incorporated into 62-330, or repealed altogether

SWFWMD's 40D-4.091 incorporates documents by reference, 40D-1.607 contains fee schedule

Chapter 62-330, F.A.C.,  
Applicants' Handbook I & II

# Incorporated by Reference

## 40D-4.091, F.A.C.

- ERP Basis of Review
- Applicant Handbook Volume II
- SWFWMD/DEP Operating Agreement
- Chapter 62-344 Delegation of ERP Programs to Local Governments
- SWFWMD/EPC MOU for Coordination of Regulated Activities
- USACE/SWFWMD Operating Agreements
- Mitigation Bank Form Documents

## What's not regulated?

The following activities are not governed by SWERP:

- Operation and Maintenance of works legally in existence
- Activities approved in an issued permit
- Activities that qualify for and are authorized by a “10-2” general permit
- Exempt activities
- Activities proposed in an application complete prior to the Oct 1<sup>st</sup> effective date
- Minor Modifications to ERP's that **lessen or do not increase impacts (Applicant can choose to submit as a SWERP)**
- Activities that do not exceed any of the “thresholds”(see next slide)

## Then what is regulated? The “thresholds”...

- In, on, or over wetlands or other surface waters
- More than 4,000 square feet of impervious and semi-impervious surface areas subject to vehicular traffic
- More than 9,000 square feet impervious and semi-impervious surface area;
- A project area of more than one acre
- Impounding more than 40 acre-feet
- A dam having a height of more than 10 feet
- Part of a larger common plan of development or sale
- A dry storage facility storing 10 or more vessels
- Exceeding the thresholds in section 1.2 of Volume II (Currently no additional District specific thresholds for SWFWMD)
- Modification or alteration of a project previously permitted under Part IV of Chapter 373, F.S. (that does not meet grandfathering provision of 373.4131)

## **62-330.050: Procedures for Review and Agency Action on Exemption Requests**

- Generally grouped by related activities
- Verification generally\* not required
- Agency must make “reasonable efforts” to verify (or request additional info needed to verify) within 30 days
- Multiple verifications allowed – only 1 fee per parcel
- Verification is agency action, subject to Ch. 120, F.S., but self-certification is not (although invalidation of a self-cert by the agency is...)
- Subject to provisions of no adverse impacts in 62-330.050(9)



## **62-330.050(9) – *no adverse impacts***

- a) Activities shall not exceed a permitting threshold in section 1.2 of the applicable Volume II
- b) Construction, alteration, and operation shall not:
  - 1. [Adversely impact water flow, storage or conveyance, or cause flooding]
  - 2. [Adversely impact MFLs]
  - 3. [Adversely impact a Work of the District]
  - 4. [Adversely impact navigation]
  - 5. [Cause or contribute to a violation of WQ standards]
- c) [When in waters accessible to listed spp.]:  
[Comply with special conditions 1. – 4. for protection of manatees, sawfish, sea turtles, sturgeon, etc.]

## 62-330.050-0511: Exemptions

- Existing exemptions written in clearer language and grouped by similarity
- Rule refers the reader to statutes
- Multiple exemptions can be verified through one request, with one fee
- Many New Exemptions

# NEW Exemptions: 62-330.051-0511

- WMD-specific exemptions – AGSWM Exemptions
- Road resurfacing
- Dusty Roads – paving of existing unpaved roads
- Culvert extensions and outfalls
- Living shoreline restoration
- Construction/alteration of wholly owned artificial surface waters
- Farm ponds-373.406(13), F.S.
- Temporary construction mats in wetlands
- Aquatic Plant and Organic Material Control and Removal
- Scientific collections and measurement devices
- SFR in previously-permitted (or grandfathered) development
- Temporary utility trench
- Modification of existing waters/conveyance systems
- No-fee, noticed exemption for silvicultural systems

## 62-330.020(3): Permit Types

- **General Permits**- formerly called “noticed general permits”
- **Individual Permit**- all other ERPs, including Mitigation Banks. Mitigation Banks are also subject to criteria in Ch. 62-342, F.A.C.
- **Conceptual Approval Permit**- Now with a 20 year duration as long as construction of first phase starts within 5 years; also includes “redevelopment” conceptual permits

# Permit Types Under SWERP

Existing ERP Permit Type	SWERP Permit Type
No-Notice General Permit	10-2 Permit
Noticed General Permit	General Permit
Standard (“General”) Permit	Individual Permit
Minor System Permit	Individual Permit (unless project submitted for 10-2 Permit)
Individual Permit	Individual Permit
Mitigation Bank	Individual Permit
Conceptual	Conceptual Approval Permit
Permit Modifications	
Individual	Major Modification
Standard	Major Modification*
Letter	Minor Modification

## General Permits (62-330.52, .401-.635)

- Language simplified in many GPs
- Repetitive conditions consolidated
- Many new General Permits:

## **New General Permits (62-330.52, .401-.635)**

- Geotechnical Investigations
- Airport Airside Stormwater Management Systems (HB 599)
- Urban Infill & Redevelopment with a Conceptual Approval (SB 943)
- Stormwater Retrofits (City of Tallahassee, SB 943)
- Governmental Environmental Restoration & Enhancement
- Governmental Public Use Facilities at Public Natural Areas
- Reclamation of Eligible Phosphate Lands
- Dry Borrow Pits of < 5 Acres (from SRWMD)
- Temporary Agricultural Activities within SFWMD
- Non-production Agricultural Activities (from SWFWMD)
- Soil reclamation (recommended by SFWMD)
- Low Profile Oyster Habitat
- Soil Remediation (SFWMD)

## Individual Permits

Includes those previously classified as Individual, Standard and Standard General, “minor systems” and “stormwater” permits

- Standardized conditions of issuance and general conditions
- Clarified “ownership and control” requirements
- Provide for recording of permits to inform future landowners



# Conceptual Approval Permits

## Normal Conceptuals:

- 20-year duration, if 1<sup>st</sup> phase begins construction in 5 years.
- Future applications to construct must be consistent with the Conceptual Approval Permit, and there must have been:
  - No changes to state water quality standards
  - No changes to special basin criteria
  - No substantive changes to site characteristics

## For Urban Redevelopment or Infill:

- Required by statute
- Limited to county or municipality redevelopment or infill areas designated in Ch.163
- Requires development of BMP-based, stormwater “master plan” demonstrating net improvement
- Subsequent projects that are consistent may qualify for new GP

## 62-330.315 - Permit modifications

- **Minor modifications** to:
  - Extend duration for up to five years active permits
  - Transfer permit – change in ownership/control
  - Correct Errors or typos
  - To address changes requested by agency
  - Minor technical changes (a.k.a. letter modifications)
  - Minor changes that do not significantly alter the authorization
- **Section 6.2.1, AH Volume I** gives guidance on what may be processed as a minor modification.
- **Major modification-** exceeds minor modification thresholds

# SWERP Applicant's Handbook



- Structured after NFWFMD Handbook format
- SWFWMD ERP Basis of Review ➡ Applicant Handbook
- Two Volumes – AH I and AH II
- AH I – applies statewide and will be the same for DEP and all WMD's – Administrative, Environmental, Sediment & Erosion Control
- AH II – Follows DEP specified outline and contains District-specific water quantity & quality criteria, special requirements.
- AH II Generally not used for projects that don't require a registered professional.

# Applicant's Handbook, Volume I

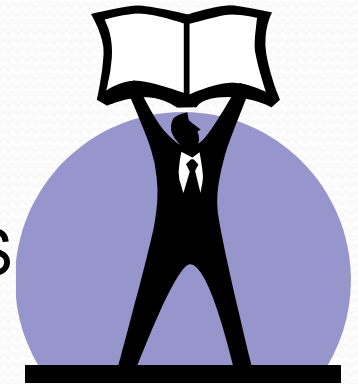

## PART I -- BACKGROUND AND PROCEDURES

- 1.0 Introduction
- 2.0 Definitions and Terms
- 3.0 Regulated Activities
- 4.0 Preparation and Submittal of Applications and Notices
- 5.0 Processing of, and Agency Action on, Applications and Notices
- 6.0 Duration, Operation, Modification, and Transfer of Permit
- 7.0 Determinations of the Landward Extent of Wetlands and Other Surface Waters

# Applicant's Handbook, Volume I



## PART II – CRITERIA FOR EVALUATION

- 8.0 Criteria for Evaluation
- 9.0 Reserved
- 10.0 Environmental Considerations
- 11.0 Erosion and Sediment Control
- 12.0 Operation and Maintenance – Specific Requirements



## **Applicant's Handbook, Volume II**

- Part I Introduction, Organization, Applicability
- Part II General Criteria
- Part III Stormwater Quantity/Flood Control
- Part IV Stormwater Quality
- Part V Construction Design Requirements
- Part VI Design Information
- Appendices

## AH II Part I – Introduction, Organization, Applicability

- Introduction
- Objectives
- Thresholds – No special SWFWMD thresholds
- **District-Specific Exemptions** – O&M existing systems, mining, normal and necessary farming (AGSWM Exemptions)
- AGSWM Agricultural Exemption Program (Agricultural Ground and Surface Water Management System)
- Criteria and Flexibility
- Simultaneous Reviews

## AH II Part II – General Criteria

- General Design and Performance Standards
- **Definitions and Terms:**      New – Aquitard  
   Combined - Surface Water or  
   Stormwater Management System  
   Facilities
- **Professional Certification Requirements** – Registered Professional
- **Tailwater Considerations** – Expanded Description
- **Retrofits** of Existing Stormwater Management Systems
- **District Drainage** Basins and Watersheds
- **Flexibility for State Transportation Projects** (HB 599)



## AH II Part III – Stormwater Quantity/Flood Control

- General Requirements
- **Offsite Discharges** – Clarification on tidal discharge requirements
- Flood Protection
- Floodplain Encroachment
- **100 Year Flood Level Determinations** – Tweaked language on validation
- Minimum Drainage -
- **Water Conservation** – Adjusted heading titles...same criteria
- Historic Basin Storage
- Offsite Lands
- Isolated Wetlands
- **Rural or Minor Subdivisions** – Added section that projects following design criteria will be presumed to meet water quantity conditions for issuance

## AH II Part IV – Stormwater Quality

- Purpose
- **Retention and Detention Criteria:** Added Wet Pool Design provision
- Public Supply Wells
- Sewage Treatment Percolation Ponds
- Solid Waste Facilities
- Alterations to Existing Public Roadway Projects – **added reference to HB 599** for flexibility in DOT water quality design criteria
- Water Quality Monitoring
- General and Special Conditions Related to Water Quality Monitoring by Permittees
- **Compensating Stormwater Treatment** – Added section to address practice of overtreatment and offsite compensation
- **Ambient Water Quality Not Meeting Standards** – Added section to address requirements for not causing or contributing to a water quality violation, and net improvement design

## AH II Part V – Construction Design Requirements

- Design Criteria
- Discharge Structures
- Control Devices/Bleed-Down Mechanisms for Detention Systems
- Maintenance Considerations
- **Retention and Detention Areas** – Dimensional Criteria, Maintenance Access
  - Wet-detention Minimum 1' depth added
- Exfiltration Systems Dimensional Criteria
- Management of Runoff from Impervious and Semi-Impervious Areas
- Stagnant Water Conditions
- Sediment Sumps
- **Dam Safety** – Added Paragraph for dam construction and design considerations
- **Rural or Minor Residential Subdivisions** – New....design procedure added
- **Sensitive Karst Areas** – New...Design considerations added

## AH II Part VI – Design Information

- Design Criteria
- Antecedent Conditions
- Rainfall Volume
- Rainfall Distribution
- Open Surface Storage
- Ground Surface Infiltration
- Subsurface Exfiltration
- **Runoff** – Receiving Water Stage considerations moved to tailwater considerations section in Part II
- Allowable Discharges

## AH II Appendices

- Appendix A Rainfall Maps
- Appendix B Wet Pool Design Alternative
- Appendix C Sensitive Karst Areas – Design Provisions
- Appendix D References and Design Aids for Stormwater Systems
- Appendix E References and Website Links for Ag BMPs
- Appendix F SWFWMD/DEP Operating Agreement

# SWERP Application Fees

# Statewide Fee Structure – 40D-1.607

Individual/Conceptual  
Fee Thresholds

District Specific  
Fees

40D-1.607,  
F.A.C.

Project Acreage

Acres Works in  
Wetlands/  
Surface Waters

Number of  
New Boat Slips

25% Reduction  
for On-line  
Applications  
for Individuals/  
Conceptuals

Retained  
Existing Fees  
Where Possible

# Project Area vs Permit Area

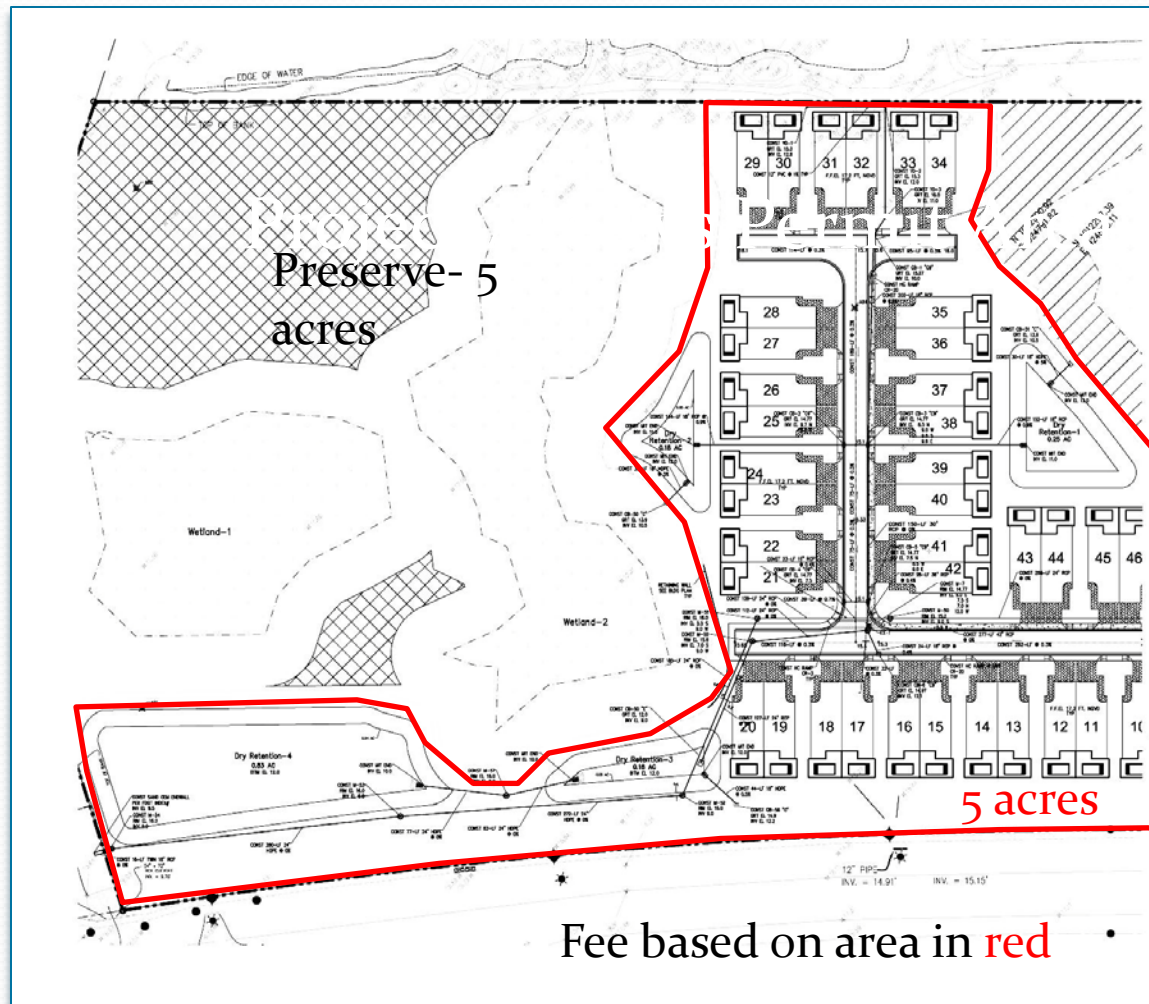

Preserve area  
= 5 acres

Permit area  
= 10 ac

Project area  
= 5 acres

Fee based on area in red •



# www.swfwmd.state.fl.us/permits/erp/

10/3/95)

## Supplemental Information

- [Stormwater Systems in Your Neighborhood](#) (July 2009)
- [Summary of ERP Responsibilities by FDEP](#) (July 2007)
- [How to Operate and Maintain Your Stormwater Management System](#) (August 2003)
- [Soil Types in the District](#) (October 2001)
- [Tips Regarding Permits for Agricultural Operations](#) (September 1999)
- [Stormwater Discharges to Impaired Waters](#)
- [NPDES Stormwater Program for Construction Activity \(for projects 1 acre or larger\)](#)
- [Florida Uniform Mitigation Assessment Method \(UMAM\) – Rules and Forms](#)

Some paper forms are still required until the ePermitting transition is complete. Please note: Data typed into these forms cannot be saved using free PDF-reader software. Please print your completed form if you would like a copy for your records. In order to save the form and data, additional software must be purchased.

[View Grandfathered  
ERP Forms »](#)

[View Statewide  
ERP Forms »](#)

- 
- [Application Fees »](#)
  - [Application and Response Submittal Guide »](#)

## Contact Us

For questions about permits and/or to [view a map](#) of the regulation service regions, contact the [permitting staff](#).

## ERP Inspection Reports

- [Inspections Due January 2013 – January 2015](#)

# ePermitting

## Environmental Resource Permit System

[Welcome](#)[New Application](#)[View Applications](#)[Your Account](#)[Preview Application](#)[Rules](#)

### Payment Options

You may pay your fee through our secure website.

Please enter the fee amount to be paid when the application is submitted to the Southwest Florida Water Management District. \$

To see a list of fees for applications, click [HERE](#)

Select the Pay Now option to pay your application fee with a credit card, check, or receipt number. The district does not receive any account details from the payment site other than a payment confirmation number.

Pay Now

If you would like to make the fee payment via a different method, please select the Submit & Pay later button below. This option may delay the review of your application

Submit and Pay Later



# Permit Fee Categories – Reduction for ePermitting

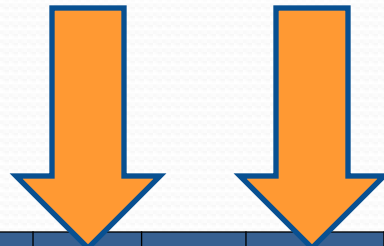

Fee Categories	Paper Application	Online	Paper Major Mod	Online Major Mod
<b>8. Fee reductions:</b>				
a. Applications for an <u>Individual or Conceptual Approval Permit</u> or modification thereof submitted using the Agency's electronic application system where the processing fee in 4 or 5 above exceeds \$250	25% Reduction			
b. Applications for any activity by an entity qualifying under Section 218.075, F.S. when the fee under paragraph (h) exceeds \$100	\$100	\$100	\$100	\$100
c. Applications for any activity when submitted by the <u>U.S. Department of Defense</u>	\$0	\$0	\$0	\$0

# Permit Fee Categories – Reduction for Major Modifications

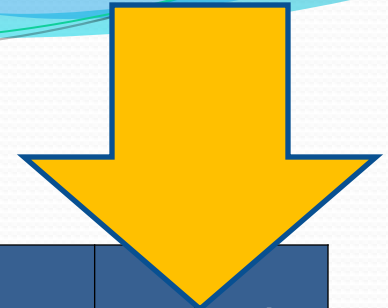

Fee Categories	Paper Application	Online	Paper Major Mod	Online Major Mod
<b>4. Individual or Conceptual Approval Permits, excluding Permits for a Mitigation Bank:</b>				
b. Major Modifications that exceed any of the thresholds in 62-330.315(3), F.A.C.:				
(I) Major Modifications to an Individual Permit that are consistent with an existing Conceptual Approval Permit	50% of the fee under Part 4 above			
(II) Major Modifications to an Individual or Conceptual Approval Permit that increase the project area	50% of the fee under Part 4 above			
(III) All other Major Modifications	50% of the fee under Part 4 above			

# Permit Fee Categories – Exemptions/General Permits

Fee Categories	Paper Application	Online
<b>2. Determination of qualification for an activity exemption:</b>		
a. Under Rules 62-330.050 and 62-330.051, F.A.C.	\$100	\$100
b. Under Rule 62-330.0511, F.A.C.	\$0	\$0
<b>3. Determination of qualification to use a General Permit</b>	\$250	\$250

# Permit Fee Categories – Individuals/Conceptuals

Fee Categories	Paper Application	Online	Paper Major Mod	Online Major Mod
<b>4. Individual or Conceptual Approval Permits, excluding Permits for a Mitigation Bank:</b>				
a. New applications – the processing fee for a new permit application shall be as determined from the categories below:				
(I) Total project area of <u>less than 10 acres</u> and <u>no activities in, on or over wetlands or other surface waters</u> , except where exempt under 62-330.051(9)(a) through (c), F.A.C.	\$364	\$291	\$182	\$182
(II) Total project area of <u>less than 10 acres</u> that does not meet 4.a.(I), above, but that involves <u>less than 1 acre of works</u> (i.e. dredging, filling, construction, or alteration) <u>in, on or over wetlands and other surface waters</u> , AND <u>less than 10 new boat slips</u>	\$2,912	\$2,330	\$1,456	\$1,165
(III) Project exceeds any of the thresholds in 4.a.(II), above, but involves a total project area of <u>less than 40 acres</u> , <u>less than 3 acres of works</u> in, on or over wetlands and other surface waters, AND <u>less than 30 new boat slips</u>	\$3,322	\$2,657	\$1,661	\$1,329
(IV) Project exceeds any of the thresholds in 4.a.(III), above, but involves a total project area of <u>less than 100 acres</u> , <u>less than 10 acres of works</u> in, on or over wetlands and other surface waters, AND <u>less than 50 new boat slips</u>	\$3,731	\$2,985	\$1,866	\$1,492
(V) Project exceeds any of the thresholds in 4.a.(IV), above, but involves a total project area of <u>less than 640 acres</u> , AND <u>less than 50 acres of works</u> in, on or over wetlands and other surface waters	\$4,141	\$3,312	\$2,070	\$1,656
(VI) Project <u>exceeds any of the thresholds</u> in 4.a.(V), above	\$4,550	\$3,640	\$2,275	\$1,820

# Permit Fee Categories – Mitigation Banks

Fee Categories	Paper Application	Online	Paper Major Mod	Online Major Mod
<b>5. Individual or Conceptual Permits for a Mitigation Bank</b>				
a. New applications for a Mitigation Bank with a permit area of:				
(I) less than 100 acres;	\$3,632	\$2,906	\$1,816	\$1,453
(II) at least 100, but less than 640 acres;	\$3,632	\$2,906	\$1,816	\$1,453
(III) 640 acres or more	\$3,632	\$2,906	\$1,816	\$1,453
b. Major Modifications involving changes to one or more of the following components: service area; credit assessment; success or release criteria; hydrologic structures or alterations; constructions or mitigation design that does not increase the project area; elimination of lands; or monitoring or management plans:				
(I) Affecting one of the above components	\$1,816	\$1,453	\$908	\$726
(II) Affecting two of the above components	\$1,816	\$1,453	\$908	\$726
(III) Affecting three of the above components	\$1,816	\$1,453	\$908	\$726
(IV) Major modifications affecting four or more of the above components or that increase the project area	\$1,816	\$1,453	\$908	\$726
c. Major Modifications that do not involve changes to the components listed in 5.b. above, but that exceed any of the thresholds in 62-330.315(3), F.A.C.:	\$1,816	\$1,453	\$908	\$726
d. Minor Modifications that do not exceed any of the thresholds in 62-330.315(3), F.A.C.:				
(I) Time Extensions of Permits, where not exempted from fees under Florida Statutes	\$0	\$0	\$0	\$0
(II) To correct minor errors that do not involve technical review, to transfer ownership of a permit, or to transfer a permit from the construction to the operation phase	\$0	\$0	\$0	\$0
(III) All other Minor Modifications	\$0	\$0	\$0	\$0
e. Mitigation Bank Credit Release	\$0	\$0	\$0	\$0
f. Mitigation Bank Credit Withdrawal	\$0	\$0	\$0	\$0



# Permit Fee Categories – Minor Modification/Variance/Waiver

Fee Categories	Paper Application	Online	Paper Major Mod	Online Major Mod
<b>6. Minor Modifications that do not exceed any of the thresholds in 62-330.315(3), F.A.C.</b>				
a. Time extensions of permits where not exempted from fees under Florida Statutes	\$0	\$0	\$0	\$0
b. To correct minor errors that do not involve technical review, to transfer ownership of a permit, or to transfer a permit from the construction to the operation phase	\$0	\$0	\$0	\$0
c. All other Minor Modifications	\$0	\$0	\$0	\$0
<b>7. Variance or Waiver:</b>				
a. Under Section 120.542, F.S.	\$0	\$0	\$0	\$0
b. Under Section 373.414(17), F.S.	\$0	\$0	\$0	\$0



# Permit Fee Categories – Wetland Determinations

Fee Categories	Paper Application	Online
<b>1. Informal Determinations, where:</b>		
a. Total area to be included in the determination is up to 1 acre	\$353	
b. Additional fee per acre (or portion thereof) beyond the first, total fee not to exceed \$500	\$20	
<b>2. Formal Determinations, where:</b>		
a. Total area to be included in the determination is less than 10 acres	\$777	\$777
b. Total area to be included in the determination is at least 10, but less than 40 acres	\$1,060	\$1,060
c. Total area to be included in the determination is at least 40, but no more than 100 acres	\$2,119	\$2,119
d. Additional fee per 100 acres (or portion thereof) that exceeds the first 100 acres	\$283	\$283
<b>3. Reissuance of Formal Determinations, in accordance with 62-330.201(5), F.A.C.</b>	\$353	\$353

# So what happens to my fees for my application that's pending?

- **No change if:**

- The application is complete OR
- The fee was paid in full OR
- We have already requested a fee in writing

- **New fee required if:**

- the application is incomplete AND
- The fee has not been paid in full OR
- We have not already requested a fee in writing

# SWERP Forms

**NOTICE OF INTENT TO USE AN ENVIRONMENTAL RESOURCE GENERAL PERMIT**

**Instructions:** This form is for projects that qualify for a General Permit in accordance with Part IV of Chapter 62-330 F.A.C. General Permits (GP) are provided for certain activities that have been determined to have minimal impacts to the water resources of the state when conducted in compliance with the terms and conditions of the general permit. Complete and submit this form to appropriate agency as identified in Part 3 below.

If activity is located on, or has the potential to be located on state-owned sovereignty submerged lands (SSL), the reviewing Agency will begin processing the request for state-owned sovereignty submerged lands approval. If you know that your project is located on SSL, complete Section F of the Environmental Resource Permit Application.

**PART 1: GENERAL INFORMATION**

**A. Rule section number of the NGP for which you are applying:** 62-330.\_\_\_\_, F.A.C.

**B. APPLICANT** ☐ **THIS A CONTACT PERSON FOR ADDITIONAL INFORMATION**

Name: Last: \_\_\_\_\_ First: \_\_\_\_\_ Middle: \_\_\_\_\_  
Company: \_\_\_\_\_  
Title: \_\_\_\_\_  
Address: \_\_\_\_\_ State: \_\_\_\_\_ Zip: \_\_\_\_\_  
City: \_\_\_\_\_ Work Telephone: \_\_\_\_\_  
Home Telephone: \_\_\_\_\_ Fax: \_\_\_\_\_  
Cell Phone: \_\_\_\_\_  
E-mail Address: \_\_\_\_\_  
Preferred correspondence method: ☐ email ☐ US Mail

**C. CONSULTANT/AGENT** ☐ **THIS A CONTACT PERSON FOR ADDITIONAL INFORMATION**

Name: Last: \_\_\_\_\_ First: \_\_\_\_\_ Middle: \_\_\_\_\_  
Company: \_\_\_\_\_  
Title: \_\_\_\_\_  
Address: \_\_\_\_\_ State: \_\_\_\_\_ Zip: \_\_\_\_\_  
City: \_\_\_\_\_ Work Telephone: \_\_\_\_\_  
Home Telephone: \_\_\_\_\_ Fax: \_\_\_\_\_  
Cell Phone: \_\_\_\_\_  
E-mail Address: \_\_\_\_\_  
Preferred correspondence method: ☐ email ☐ US Mail



Form 62-330.402(1) - Notice of Intent to Use An Environmental Resource General Permit  
Incorporated by reference in subsection 62-330.402(1), F.A.C. (Effective Date)

**JOINT APPLICATION FOR  
INDIVIDUAL ENVIRONMENTAL RESOURCE PERMIT/  
AUTHORIZATION TO USE STATE-OWNED  
SUBMERGED LANDS/  
FEDERAL DREDGE AND FILL PERMIT**

Form 62-330.000(1)

FLORIDA DEPARTMENT OF ENVIRONMENTAL PROTECTION/  
WATER MANAGEMENT DISTRICTS/  
U.S. ARMY CORPS OF ENGINEERS

Effective [Effective Date]



US Army Corps of Engineers

# Standardized Forms

- |                     |   |
|---------------------|---|
| Form 62-330.050(1)  | Request for Verification of an Exemption  |
| Form 62-330.051(1)  | Notice of Intent to Construct a Minor Silvicultural System  |
| Form 62-330.060(1)  | Joint ERP Application   |
| Form 62-330.090(1)  | Recorded Notice of Environmental Resource Permit  |
| Form 62-330.201(1)  | Petition for a Formal Determination of the Landward Extent of Wetlands  |
| Form 62-330.301(1)  | Performance Bond To Demonstrate Financial Assurance for M&M   |
| Form 62-330.301(2)  | Irrevocable Letter of Credit to Demonstrate Financial Assurance   |
| Form 62-330.301(3)  | Standby Trust Fund Agreement to Demonstrate Financial Assurance   |
| Form 62-330.301(4)  | Trust Fund Agreement to Demonstrate Financial Assurance   |
| Form 62-330.301(5)  | Escrow Agreement  |
| Form 62-330.301(6)  | Guarantee Bond to Demonstrate Financial Assurance   |
| Form 62-330.301(8)  | Deed of Conservation Easement   |
| Form 62-330.301(9)  | Deed of Conservation Easement With Third Party Beneficiary  |
| Form 62-330.301(10) | Deed of Conservation Easement for Agricultural Uses   |
| Form 62-330.301(11) | Deed of Conservation Easement for Other Uses  |
| Form 62-330.301(12) | Conservation Easement for Local Governments   |
| Form 62-330.301(13) | Conservation Easement with Third Party Beneficiary Rights to the U.S. Army Corps of Engineers                             |
| Form 62-330.301(14) | Conservation Easement Covenants   |
| Form 62-330.301(15) | Restrictive Covenants –Insert   |
| Form 62-330.301(16) | Easement for Construction Access  |
| Form 62-330.301(17) | Permanent Access Easement   |
| Form 62-330.301(18) | As-Built Certification and Request for Conversion to Operation Phase  |
| Form 62-330.301(19) | Request For Transfer of Environmental Resource Permit to the Perpetual Operation Entity                                   |
| Form 62-330.301(20) | Construction Completion and Inspection Certification for Activities Associated With a Private Single-Family Dwelling Unit |
| Form 62-330.301(21) | Operation and Maintenance Inspection Certification  |
| Form 62-330.311(1)  | Regional Stormwater Management System Annual Report   |
| Form 62-330.311(2)  | Request to Transfer Permit  |
| Form 62-330.340(1)  | Construction Commencement Notice  |
| Form 62-330.350(1)  | Emergency Field Authorization   |
| Form 62-330.360(1)  | Notice of Intent to Use an Environmental Resource General Permit  |
| Form 62-330.402(1)  | Agreement to Maintain Public Access   |
| Form 62-330.417(1)  | Agreement to Maintain Public Access and Operate Stormwater System   |
| Form 62-330.417(2)  |   |

# www.WaterMatters.org

Southwest Florida  
Water Management District

BALANCING WATER NEEDS... PROTECTING WATER RESOURCES

About the District

Agriculture

Boards, Meetings  
& Events Calendar

Business & Finance

Data & Maps

Documents &  
Publications

Education

Employment

ePermitting & Rules

Florida-Friendly  
Landscaping

Newsroom

Projects & Programs

Recreation

Springs in West-  
Central Florida

Water Conservation

Weather & Hydrology

An Online System to Apply for and Search District Permits



SITE SEARCH:

search

Featured Topics



[After the Flood](#)

[Central Florida Water Initiative](#)

Most Recent Webpages

[Springs in West-Central Florida](#)

[Water: From the Ground to the Tap and Back](#)

[Daily Hydrologic Data](#)

[Monthly Lake Wales Ridge Lake-Level Updates](#)

[Chassahowitzka Springs Restoration Project](#)

Publications

Order or Download  
FREE Publications

 [Fix It for Less Brochure](#)

 [A Do-It-Yourself Guide to Florida-Friendly Fertilizing](#)

 [Saving Water Indoors in Spanish](#)



# www.swfwmd.state.fl.us/permits/erp/

10/3/95)

## Supplemental Information

- [Stormwater Systems in Your Neighborhood](#) (July 2009)
- [Summary of ERP Responsibilities by FDEP](#) (July 2007)
- [How to Operate and Maintain Your Stormwater Management System](#) (August 2003)
- [Soil Types in the District](#) (October 2001)
- [Tips Regarding Permits for Agricultural Operations](#) (September 1999)
- [Stormwater Discharges to Impaired Waters](#)
- [NPDES Stormwater Program for Construction Activity \(for projects 1 acre or larger\)](#)
- [Florida Uniform Mitigation Assessment Method \(UMAM\) – Rules and Forms](#)

Some paper forms are still required until the ePermitting transition is complete. Please note: Data typed into these forms cannot be saved using free PDF-reader software. Please print your completed form if you would like a copy for your records. In order to save the form and data, additional software must be purchased.

[View Grandfathered  
ERP Forms »](#)

[View Statewide  
ERP Forms »](#)

- [Application Fees »](#)
- [Application and Response Submittal Guide »](#)

## Contact Us

For questions about permits and/or to [view a map](#) of the regulation service regions, contact the [permitting staff](#).

## ERP Inspection Reports

- [Inspections Due January 2013 – January 2015](#)

# Standardized Forms - Applications

Number	Description
62-330.050(I)	*Request for Verification of an Exemption
62-330.0511(I)	*Notice of Intent to Construct a Minor Silvicultural System
62-330.402(I)	*Notice of Intent to Use an General Permit
62-330.060(I)	*Joint ERP Application
62-330.201(I)	*Petition for a Formal Determination of the Landward Extent of Wetlands and Other Surface Waters
62-330.340(I)	Request to Transfer Permit

\*ePermitting collects the required information in lieu of these forms.

# Supplemental Sections

Section	Description
B	Single Family Residence (including duplex, triplex, or quadruplex)
C	Works in Wetlands or Surface Waters or within 25 feet of a wetland or surface water
D	Multi-slip Dock or Marina, dry storage facility, dredging, breakwaters, reefs (in addition to C)
E	Water Management System
F	State-owned Submerged Lands
G	Mitigation Banking
H	Mining

All Supplemental Forms are listed as possible attachments in ePermitting



# Standardized Forms – Financial Responsibility

Number	Description
62-330.301(1)	Performance Bond To Demonstrate Financial Assurance for Mitigation
62-330.301(2)	Irrevocable Letter of Credit to Demonstrate Financial Assurance for Mitigation
62-330.301(3)	Standby Trust Fund Agreement to Demonstrate Financial Assurance for Mitigation
62-330.301(4)	Trust Fund Agreement to Demonstrate Financial Assurance for Mitigation
62-330.301(5)	Escrow Agreement
62-330.301(6)	Guarantee Bond to Demonstrate Financial Assurance for Mitigation

All Financial Responsibility Forms are listed as possible attachments in ePermitting

# Standardized Forms – Easements

Number	Description
62-330.301(8)	Deed of Conservation Easement – Standard
62-330.301(9)	Deed of Conservation Easement – Standard, With Third Party Beneficiary
62-330.301(10)	Deed of Conservation Easement – Passive Recreational Uses
62-330.301(11)	Deed of Conservation Easement - Riparian Use
62-330.301(12)	Deed of Conservation Easement for Local Governments
62-330.301(13)	Deed of Conservation Easement with Third Party Beneficiary Rights to the U.S. Army Corps of Engineers
62-330.301(16)	Temporary Easement for Construction Access
62-330.301(17)	Permanent Access Easement

All Easement Forms are listed as possible attachments in ePermitting

# Standardized Forms - Compliance

Number	Description
62-330.310(1)	As-Built Certification and Request for Conversion to Operation Phase
62-330.310(2)	Request For Transfer of Environmental Resource Permit to the Perpetual Operation Entity
62-330.311(1)	Operation and Maintenance Inspection Certification
62-330.311(2)	Regional Stormwater Management System Annual Report
62-330.350(1)	Construction Commencement Notice

Forms available on the web and will be handled through eCompliance in the future

# 62-330.340 Permit Transfers

## Permits in O&M Phase

- 373.426 and 373.429, F.S. allow for notification within 30 days to receive automatic transfer to new owner
- Otherwise, subject to below criteria
- eCompliance will handle in the future for ERP and SWERP

## Permits **not** in O&M Phase

- **SWERP**
  - 62-330.340(I) Request to Transfer Permit Form Required
  - Processed as minor modification
  - Can be done through ePermitting
- **ERP**
  - old forms
  - eCompliance will handle in the future

# 62-330.310 Operation and Maintenance

## As-built Certification

- 62-330.310(4)(a) I.a, F.A.C.
- 62-330.310(1) – As-built Certification and Request for Conversion to Operation Phase Form
- Certification conducted by registered professional
- As-builts required if there are substantial deviations
- District has 60 days to approve or provide notification of deficiencies

## Transfer to O&M Entity

- 62-330.310(4)(a) I.b, F.A.C.
- 62- 330.310(2) – Request for Transfer of Permit to Perpetual Operation and Maintenance Entity Form
- Required to be submitted within 30 days of as-built certification
- Suggest continuing to submit this simultaneously with as-built certification

eCompliance will handle these in the future

# 62-330.311 Inspections and Reporting

## Inspections and Reporting

- 62-330.311, F.A.C.
- 62-330.311(1) – O&M Inspection Certification Form
  - Inspections are Required
    - 24 Months for Effluent Filtration or Exfiltration
    - 60 Months for Retention/Detention
- Required to be submitted upon any failure or deviation from permit or at request of District
- 62-330.311(5), F.A.C. – Allows for permit modifications to reflect inspection and reporting under this rule

eCompliance will handle these in the future

# 62-330.090(7) Permit Recording

## Recording Permits with County

- 62-330.090(7), F.A.C.
- 62-330.090(1) – Recorded Notice of Environmental Resource Permit Form
- District will be covering this activity
- Not Required for:
  - Individual, single-family residence, duplex, triplex, quadruplex not part of a larger common plan of development/sale
  - General Permits
  - Temporary activity, less than one year
  - No long term maintenance or operation requirements
  - Federal, state, county, or municipal government
  - Within permit area of existing permit for which a notice has already been recorded and modification does not change the permit area.

# SWERP ePermitting Changes



# ePermitting - SWERP

- **SWERP Effective 10/1/2013**
- **ePermitting Changes Effective 10/7**
  - ePermitting down 10/4 at 5 p.m. to 10/7 at 6 a.m.
  - Any applications in draft status on 10/4 at 5 p.m. will be restarted
  - Any attachments will be preserved
- **Can still use ePermitting to apply until 10/4**
  - We will update your application
  - Application must be “submitted” prior to 5 p.m. on 10/4
- **Registered for Notice of Receipt of Application by Type of ERP?**
  - Will have to re-register to select new permit type after 10/7

# ePermitting – SWERP

## Environmental Resource Permit System

[Welcome](#)[New Application](#)[View Applications](#)[Your Account](#)[Preview Application](#)[Rules](#)

### Permit Information

[Exemption](#)[General](#)[Standard General \(Modification Only\)](#)[Individual](#)[Minor System \(Modification Only\)](#)[Petition for Formal Determination](#)[Conceptual](#)[Site Condition Assessment \(Modification Only\)](#)

# ePermitting – SWERP

## Environmental Resource Permit System

[Welcome](#)[New Application](#)[View Applications](#)[Your Account](#)[Preview Application](#)[Rules](#)

### Individual

#### Statewide Environmental Resource Permit

- ☐ Individual Environmental Resource Permit Rule:(62-330.054)
- ☐ Minor modification request Rule:(62-330.315(2))
- ☐ Major modification Request Rule:(62-330.315(3))
- ☐ Application for Permit Modification to extend the existing permit duration of a construction permit - Individual Rule:(62-330.315(2)(a))

#### Grandfathered Environmental Resource Permit (Modification Only)

- ☐ A request to modify a general construction permit by submittal of an Environmental Resource Permit Modification Rule:(40D-40.331(2)(a))
- ☐ A request to modify an individual permit by submittal of an Environmental Resource Permit Modification Short Form Rule:(40D-4.331(2)(b))

# ePermitting – Grandfathered Permits

## Environmental Resource Permit System

[Welcome](#)[New Application](#)[View Applications](#)[Your Account](#)[Preview Application](#)[Rules](#)

### Permit Information

Exemption

☐

General

☐

Standard General (Modification Only)

☐

Individual

☐

Minor System (Modification Only)

☐

Petition for Formal Determination

☐

Conceptual

☐

Site Condition Assessment (Modification Only)

☐

# ePermitting – Grandfathered Permits

## Environmental Resource Permit System

[Welcome](#)[New Application](#)[View Applications](#)[Your Account](#)[Preview Application](#)[Rules](#)

### Permit Information

Exemption

☒

General

☐

Standard General (Modification Only)

☐

Individual

☐

Minor System (Modification Only)

☐

Petition for Formal Determination

☐

Conceptual

☐

Site Condition Assessment (Modification Only)

☐

# ePermitting – Grandfathered Permits

## Environmental Resource Permit System



[Welcome](#)[New Application](#)[View Applications](#)[Your Account](#)[Preview Application](#)[Rules](#)

### Individual

#### Statewide Environmental Resource Permit

- ☐ Individual Environmental Resource Permit Rule:(62-330.054)
- ☐ Minor modification request Rule:(62-330.315(2))
- ☐ Major modification Request Rule:(62-330.315(3))
- ☐ Application for Permit Modification to extend the existing permit duration of a construction permit - Individual Rule: (62-330.315(2)(a))

#### Grandfathered Environmental Resource Permit (Modification Only)

- ☐ A request to modify a general construction permit by submittal of an Environmental Resource Permit Modification Rule: (40D-40.331(2)(a))
- ☐ A request to modify an individual permit by submittal of an Environmental Resource Permit Modification Short Form Rule:(40D-4.331(2)(b))

# ePermitting and GIS Training

We offer on-site training!

Call x5678 or email  
[WMISHelpDesk@watermatters.org](mailto:WMISHelpDesk@watermatters.org)

Reduced Processing Times

Reduced Application Fee for Individual  
and Conceptual Applications

eCompliance coming soon



Questions/Comments?